



**Perform-A-Deck<sup>®</sup>**  
INTEGRAL ROOF DECK ASSEMBLY



**Martin**

**FIREPROOFING**

Roof Deck Specialists  
for Over 75 Years

[www.martinfireproofing.com](http://www.martinfireproofing.com)

# YOU CAN HAVE IT ALL

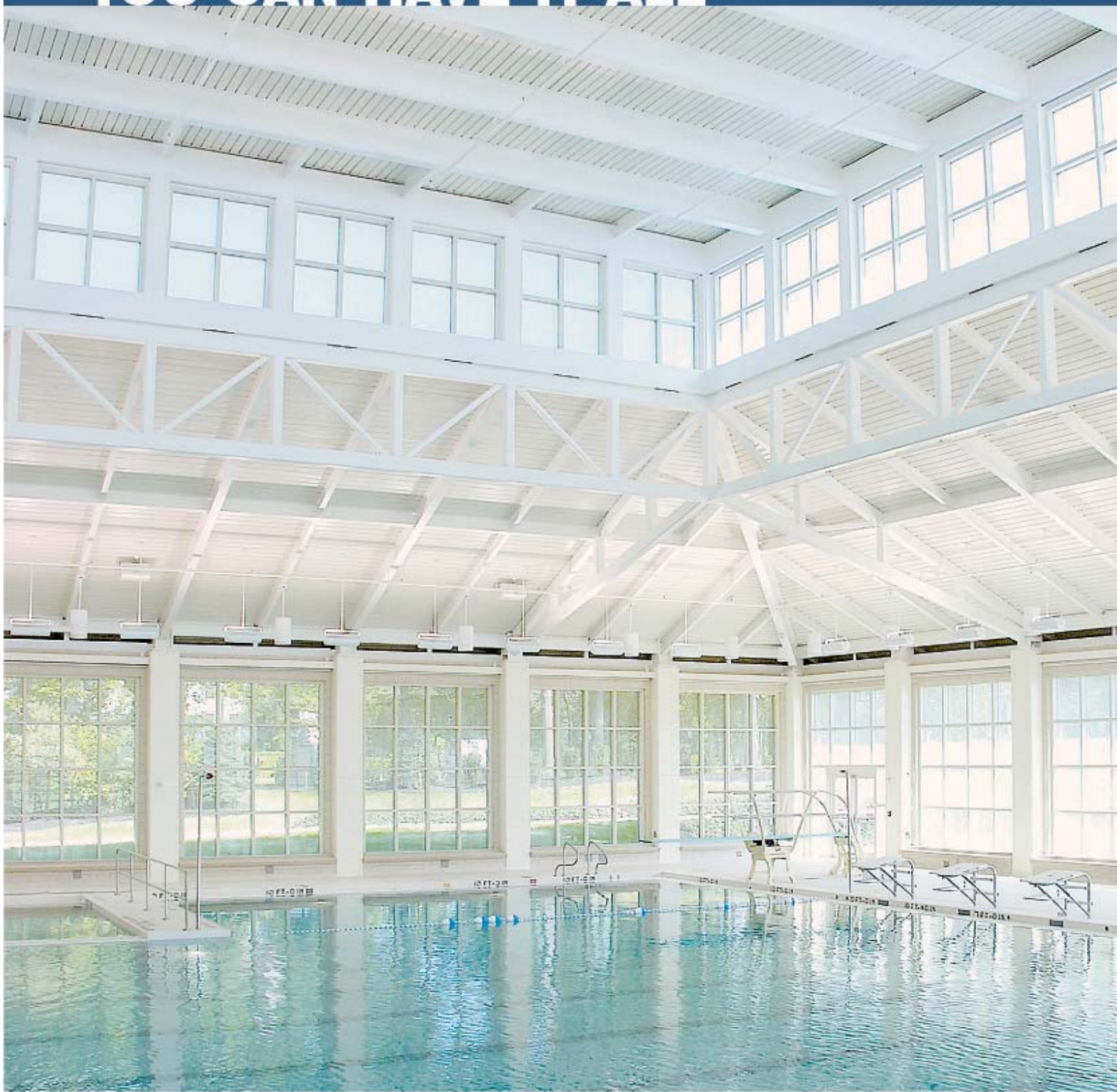

Durable, insulated, acoustically enhanced — and attractive, too!

**Perform-A-Deck** is a roof deck system offering a unique combination of superior quality plus architectural beauty:

- outstanding structural strength with time-proven steel component
- maximum energy efficiency from high quality insulation foam
- optimum acoustical values
- excellent waterproofing protection
- UL Fire Rated designs
- sturdy nailing surface for simple attachment of roofing system

## Perform-A-Shield Waterproofing Protection

The **Perform-A-Deck** system includes two options of moisture protection components. One consists of a base sheet product

which is compatible with the specified roofing material. The other is Perform-A-Shield, a high quality self-stick modified bitumen material which offers superior protection as a roof underlayment compatible with the specified roofing material.

## 10-Year Performance Warranty

The **Perform-A-Deck** roof deck system is designed to provide the most efficient, economical and long lasting roof deck system available. Perform-A-Deck is extensively evaluated and warranted by the full support of one of the most experienced roof deck companies in the world.

A 10-Year Performance Warranty is standard on all **Perform-A-Deck** roof deck systems.



**Edenbrook Facility**  
Huntsville, AL

**Architect:**  
HDR Architects, Inc., Dallas, TX

**Contractor:**  
Choate Construction Co., Marietta, GA

**Size:** 29,000 Sq. Ft.



**Greer Elementary School**  
Brunswick, GA

**Architect:**  
John A. Tuten & Assoc., Brunswick, GA

**Contractor:**  
Mitchell Construction Co., Atlanta, GA

**Size:** 84,000 Sq. Ft.



**Wesleyan School**  
Norcross, GA

**Architect:**  
Chapman Coyle Chapman & Assoc.  
Marietta, GA

**Contractor:**  
New South Construction, Atlanta, GA

**Size:** 75,200 Sq. Ft.

# More Than Just a Roof Deck

## Job Specific Designed System

Martin Fireproofing offers Spec-Check Profile, a computer generated specification system, on all of its products. The design professional simply submits a one-page form and we send back the Perform-A-Deck Roof Deck System Design Proposal.

## Top Quality Engineered Roof Deck

Only the highest quality products are used to provide you with an engineered deck with the best Diaphragm Ratings, Load Ratings and R-Values.

## Skilled Installation Team

Our installation team is the best in the industry, giving you a high quality professional installation in a very timely fashion.

## Knowledgeable Technical Support

The Technical Support Department at Martin Fireproofing is a valuable resource to our customers. It is available for consultation on any issue regarding your roof deck design and performance.

## Friendly Customer Service

Martin Fireproofing strives to provide the very best in service, from your first phone call to the day your building is dried-in.

**Perform-A-Deck**  
INTEGRAL ROOF DECK ASSEMBLY

## Codes & Compliance

Martin Fireproofing is a member of the International Code Council, the most widely accepted organization in modern building codes.

### Underwriters Laboratories, Inc.

- UL 790 (ASTM E 108) Class A component
- Hourly Rated P-Series Assemblies (UL 263)
- Class 90 Wind Uplift Rating (UL 580)

### Factory Mutual Research

- FM Class 1 approval for steel roof deck constructions, Class 1 Fire and 1-60 and 1-90 windstorm classification (FM 4450)

### Hurricane Impact Resistance

- Ref: Test Protocols for High Velocity Hurricane Zones 2001 SSTD 12-99

### Federal Specification

- Meets physical property requirements of HH-I-19972/GEN
- Florida Building Code Approval
- Miami & Dade County Approval

## Specification Services

### Spec-Check Profile

Martin Fireproofing's Perform-A-Deck Roof Deck System Design Proposal is a service provided to the design professional to assist in specifying the best and most economical roof deck assembly possible to achieve the performance requirements.

The Design Proposal utilizes the Spec-Check Profile input data to develop a specification for a project. It clearly describes the Perform-A-Deck system for the project including sample details. Our Perform-A-Deck representatives are trained to work closely with the design professional to ensure the Design Proposal is accurate and the process is completed expeditiously.

## Warranty

Martin Fireproofing Corporation offers a 10-Year Performance Warranty on all Perform-A-Deck roof deck systems at no extra charge to the customer.

## Insulation & R-Value

Polyisocyanurate Insulation				
Insulation Thickness	Insulation Layers	R-Value Product Only	Total 'In-Place' Assembly R-Value	
			Heat Flow Up	Heat Flow Down
1.0'	1	6.0	7.58	7.78
1.5'	1	9.0	10.58	10.78
2.0'	1	12.1	13.68	13.88
2.5'	2	15.3	16.88	17.08
3.0'	2	18.5	20.26	20.46
3.5'	2	21.7	23.46	23.66
4.0'	2	25.0	26.76	26.96

- NOTES • Total 'In-Place' R-Values are calculated from air to air, including values for shingles, underlayment and one layer of 5/8" gypsum board.  
 • Add 0.67 to total R-Values for each additional layer of 5/8" gypsum board.  
 • The R-Value for the insulation component is based on PIMA LTTR Technical Bulletin and ASTM C1303.

Expanded Polystyrene Insulation						
Total Thickness	# of Boards (layers)	Layer 1 (inches)	Layer 2 (inches)	R-Value (Inches)		
				@ 25°F	@ 40°F	@ 75°F
1'	1	1	-	5.00	4.60	4.35
2'	1	2	-	10.00	9.20	8.70
3'	1	3	-	17.97	13.80	12.99
4'	1	4	-	23.79	18.40	17.24
5'	1	5	-	30.01	23.00	21.74
2'	2	1	1	10.00	9.20	8.70
3'	2	1	2	15.00	14.03	13.05
4'	2	1	3	22.97	19.66	16.34
5'	2	1	4	28.79	25.19	21.59
6'	2	2	4	33.79	29.87	25.94
7'	2	2	5	40.01	35.24	30.44

- NOTES • Conditioned R-Values for expanded polystyrene insulation boards based on ASTM Test Method C 518.

## Insulated

Perform-A-Deck insulated systems can provide R-Values up to 36.95, giving you maximum energy saving designs. We offer various types of insulation including expanded polystyrene and polyisocyanurate.

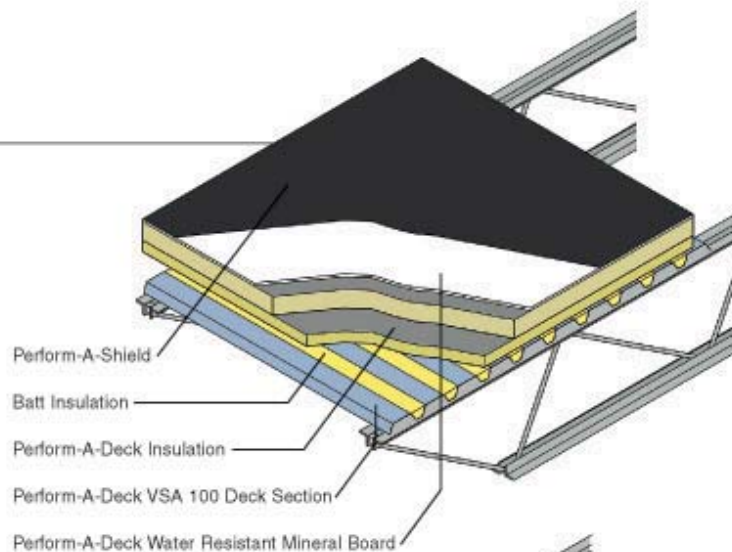

## Acoustical

Perform-A-Deck systems can all be designed to provide high acoustical values while still consisting of both insulated and Fire Rated systems. NRC values up to 1.15 can be achieved with our systems.

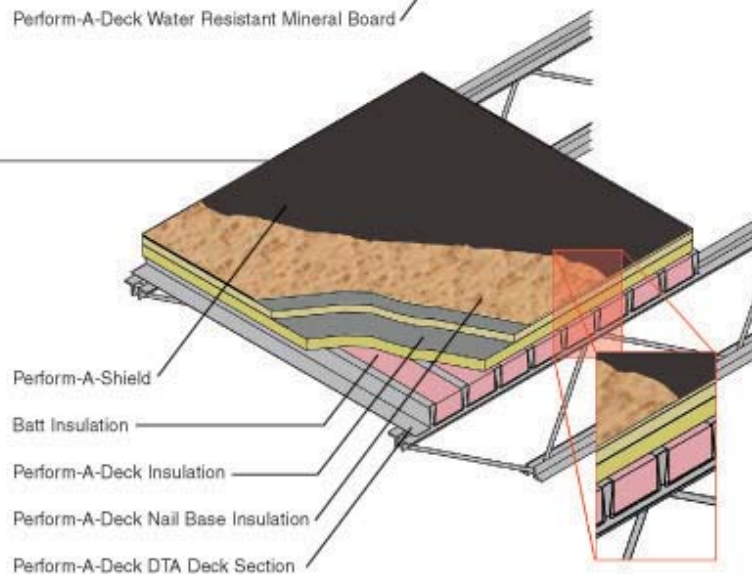

## Fire Rated

Perform-A-Deck systems offer a wide range of UL Fire Rated designs. By utilizing a 5/8" Type-X gypsum board over the steel section, these systems will meet the requirements of many U.L. hourly rated tests.

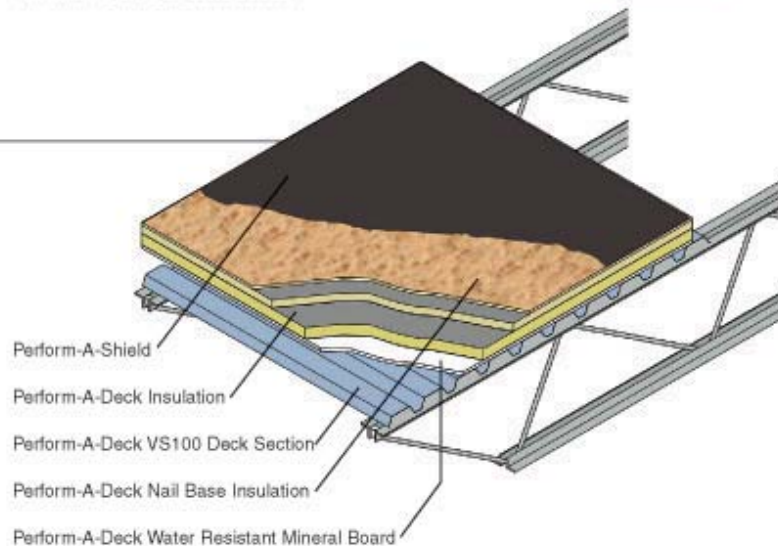

*The illustrations above are just a small sample of the various systems we can design for you. We can offer you optional available surfaces such as OSB, plywood and gypsum. Vented nail base insulations are also available.*

**Perform-A-Deck**<sup>®</sup>  
INTEGRAL ROOF DECK ASSEMBLY

## VS 100 Section Properties

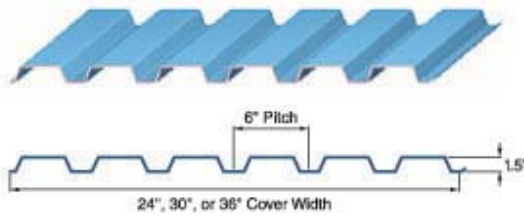

VS 100 Span	Single Span Gauge			Double Span Gauge			Triple Span Gauge		
	22	20	18	22	20	18	22	20	18
4'-0"	187	235	318	253	312	400	311	384	400
4'-6"	134	168	226	201	248	332	245	306	400
5'-0"	101	125	167	163	202	270	181	227	307
5'-6"	78	96	128	135	167	224	138	173	233
6'-0"	62	76	101	114	141	188	109	135	181
6'-6"	51	62	81	97	120	161	88	108	145
7'-0"	43	52	67	84	104	139	72	89	118
7'-6"	36	44	56	73	90	121	60	74	98
8'-0"	32	38	48	63	77	102	51	63	82
8'-6"	-	33	42	54	66	87	44	54	70
9'-0"	-	-	37	47	57	75	39	47	60
9'-6"	-	-	32	41	50	65	34	41	53

## VS 200 Section Properties

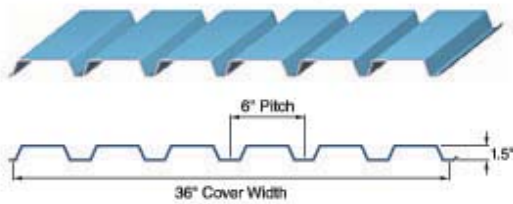

VS 200 Span	Single Span Gauge			Double Span Gauge			Triple Span Gauge		
	22	20	18	22	20	18	22	20	18
3'-0"	297	370	400	317	385	400	393	400	400
3'-6"	218	272	372	234	285	377	291	353	400
4'-0"	152	189	256	180	219	289	224	272	360
4'-6"	109	136	182	142	173	229	177	215	285
5'-0"	82	102	135	115	140	186	144	175	232
5'-6"	64	79	104	95	116	154	112	140	188
6'-0"	52	63	82	80	97	129	89	110	147
6'-6"	43	51	67	68	83	110	72	88	118
7'-0"	36	43	55	59	72	95	59	73	96
7'-6"	31	37	47	51	62	83	50	61	80
8'-0"	-	32	40	45	55	73	43	52	67

## VS 300 Section Properties

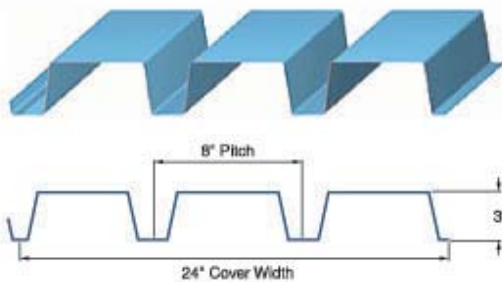

VS 300 Span	Single Span Gauge			Double Span Gauge			Triple Span Gauge		
	22	20	18	22	20	18	22	20	18
7'-0"	122	186	263	142	203	318	153	231	387
7'-6"	114	153	216	132	189	277	143	215	344
8'-0"	99	128	179	124	175	244	134	202	303
8'-6"	84	108	151	117	156	217	126	190	269
9'-0"	72	92	129	108	139	194	119	166	234
9'-6"	63	80	111	97	125	174	110	142	201
10'-0"	55	70	97	88	113	157	96	123	173
10'-6"	49	62	85	79	102	143	84	108	151
11'-0"	44	55	75	72	93	130	74	95	133
11'-6"	40	49	67	66	85	119	66	84	117
12'-0"	36	44	60	61	78	109	59	75	104
12'-6"	33	40	54	56	72	101	54	68	93
13'-0"	30	37	49	52	67	93	49	61	84

## AS 100 Section Properties

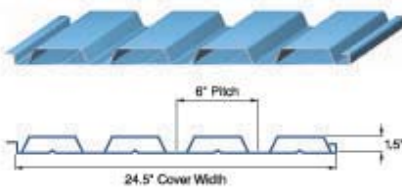

AS 100 Span	Single Span Gauge						
	20/20	20/18	18/20	18/18	18/16	16/16	14/14
6'-0"	137	149	174	190	203	243	301
7'-0"	90	97	113	123	132	156	193
8'-0"	63	68	79	85	91	108	132
9'-0"	47	51	58	63	67	79	96
10'-0"	37	40	45	48	51	60	72
11'-0"	30	32	36	39	41	47	57
12'-0"	-	-	30	32	34	39	46
13'-0"	-	-	-	-	-	32	38
14'-0"	-	-	-	-	-	-	32

## AS 200 Section Properties

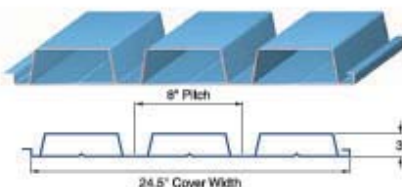

AS 200 Span	Single Span Gauge						
	20/20	20/18	18/20	18/18	18/16	16/16	14/14
8'-0"	164	164	274	291	294	400	400
9'-0"	145	145	196	212	225	284	371
10'-0"	110	118	145	157	167	210	273
11'-0"	85	91	111	120	128	160	207
12'-0"	67	72	88	95	101	125	162
13'-0"	55	59	71	77	81	101	129
14'-0"	46	49	59	63	67	82	105
15'-0"	39	42	50	53	56	69	88
16'-0"	34	36	43	45	48	58	74

## ACOUSTICAL

All systems are available as an acoustical roof deck.

**NRC Values up to 1.15**

**Perfect for:**

- Auditoriums
- Restaurants
- Churches
- Natatoriums
- Cafeterias

## DT 100 Section Properties

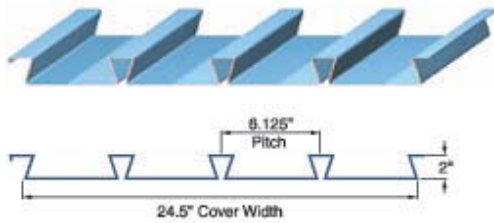

DT 100 Span	Single Span Gauge			Double Span Gauge			Triple Span Gauge		
	22	20	18	22	20	18	22	20	18
6'-6"	106	127	167	159	198	273	191	231	306
7'-0"	87	104	135	137	171	236	155	187	247
7'-6"	72	86	112	120	149	206	128	154	202
8'-0"	61	73	94	105	131	181	107	128	168
8'-6"	53	62	80	93	116	160	91	109	142
9'-0"	46	54	69	83	104	143	78	93	121
9'-6"	40	47	60	75	93	128	68	80	104
10'-0"	36	42	53	67	84	113	59	70	91
10'-6"	32	37	47	61	76	99	53	62	80
11'-0"	-	34	42	56	68	88	47	55	71
11'-6"	-	31	38	51	61	78	42	50	63
12'-0"	-	-	34	46	54	70	38	45	57
12'-6"	-	-	32	42	49	63	35	41	51
13'-0"	-	-	-	38	45	57	32	37	47

## DT 200 Section Properties

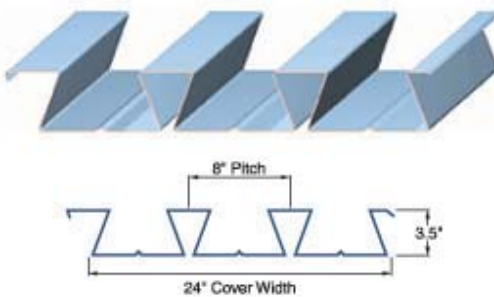

DT 200 Span	Single Span Gauge			Double Span Gauge			Triple Span Gauge		
	20	18	16	20	18	16	20	18	16
8'-0"	174	320	400	213	355	400	218	400	400
9'-0"	155	253	324	190	315	400	194	355	400
10'-0"	137	187	239	171	284	394	174	320	400
11'-0"	105	143	182	155	252	326	158	261	334
12'-0"	83	112	142	142	212	275	145	203	259
13'-0"	68	90	114	121	181	234	119	162	206
14'-0"	56	74	93	105	156	202	97	131	167
15'-0"	47	62	77	91	136	173	81	108	137
16'-0"	41	53	65	80	114	144			
17'-0"	36	46	56	71	96	122			
18'-0"	31	40	49	62	83	104			
19'-0"	-	35	43	54	72	90			
20'-0"	-	32	38	48	63	78			
21'-0"	-	-	34	43	56	69			
22'-0"	-	-	31	38	50	61			
23'-0"	-	-	-	35	45	55			
24'-0"	-	-	-	32	40	49			

FM & FM (A) Factory Mutual Allowable Span is Pending

## PS 100 Section Properties

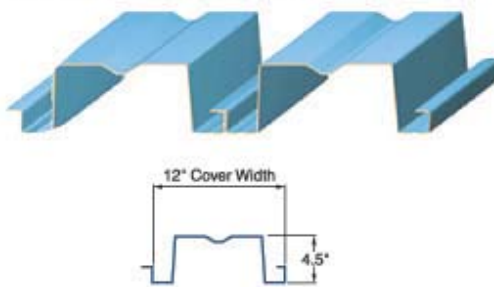

PS 100 Span	Single Span Gauge				Double Span Gauge				Triple Span Gauge			
	20	18	16	14	20	18	16	14	20	18	16	14
7'-0"	214	400	400	400	180	334	400	400	205	380	400	400
8'-0"	187	357	400	400	158	292	400	400	179	332	400	400
9'-0"	166	317	400	400	140	260	400	400	159	295	400	400
10'-0"	149	269	338	400	126	234	383	400	143	266	400	400
11'-0"	136	204	257	318	115	212	348	400	130	241	395	400
12'-0"	119	160	200	247	105	195	319	400	119	221	362	400
13'-0"	96	128	159	197	97	180	294	375	110	204	292	362
14'-0"	78	104	129	159	90	167	258	324	102	188	235	292
15'-0"	66	86	107	131	84	156	225	283	95	154	193	239
16'-0"	56	73	90	110	79	146	198	249	89	129	161	199
17'-0"	48	62	76	90	74	137	171	211				
18'-0"	42	54	66	80	70	117	145	179				
19'-0"	37	47	57	69	66	101	125	154				
20'-0"	33	42	51	61	63	88	108	133				

## PS 200 Section Properties

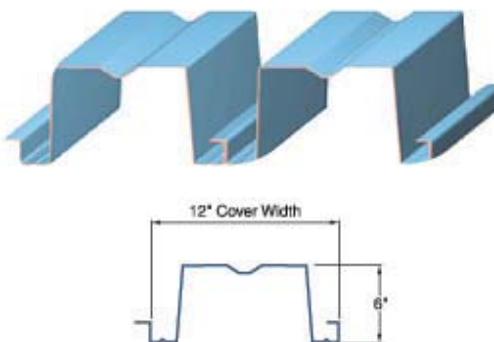

PS 200 Span	Single Span Gauge				Double Span Gauge				Triple Span Gauge			
	20	18	16	14	20	18	16	14	20	18	16	14
10'-0"	131	257	400	400	110	210	351	400	125	239	399	400
11'-0"	119	234	394	400	100	191	319	400	114	217	362	400
12'-0"	109	214	361	400	92	175	292	400	104	199	332	400
13'-0"	100	198	299	371	85	162	270	400	96	184	307	400
14'-0"	93	184	241	299	79	150	250	400	89	171	285	400
15'-0"	87	158	198	245	73	140	234	376	83	159	266	400
16'-0"	81	132	165	204	69	131	219	352	78	149	249	375
17'-0"	77	112	139	171	65	124	206	324				
18'-0"	72	96	119	146	61	117	195	290				
19'-0"	63	83	102	125	58	110	184	261				
20'-0"	55	72	89	109	55	105	175	236				
21'-0"	49	64	78	95	52	100	167	214				
22'-0"	44	57	69	84	50	95	153	189				
23'-0"	40	51	62	75	48	91	135	167				
24'-0"	36	46	56	67	46	87	120	148				
25'-0"	33	42	50	60								

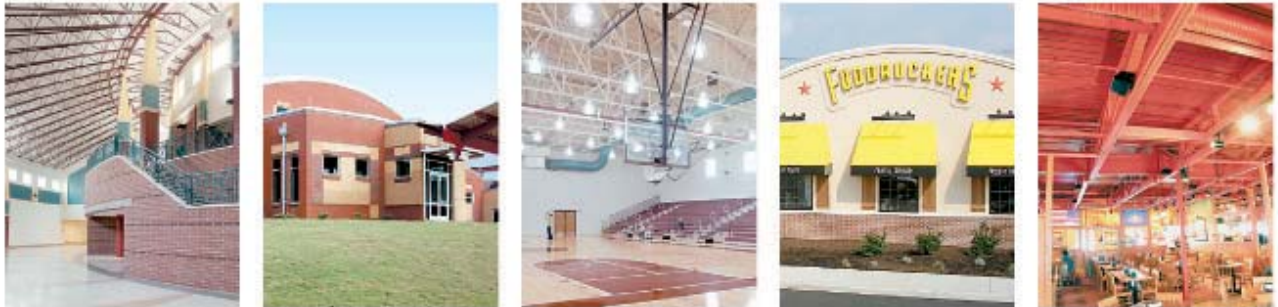

*Celebrating over 75 years of providing the Roof Deck Industry  
with the best products and services available*

Since 1930 Martin Fireproofing has delivered only the highest quality products to the building design community. With a dedicated staff of service representatives, engineering support and management we will continue our growth through product innovation, superior products, the highest level of service before and after the sale and always placing the customer first.

Our office and engineering facilities are fully equipped with state-of-the-art technology. We are continuously updating our systems to ensure unparalleled quality and service from initial design stages to successful project completion.

From sales to management to engineering, the Martin Fireproofing Perform-A-Deck team of knowledgeable professionals is at your service throughout the entire design and construction process.



Mailing Address: P.O. Box 27 • Kenmore Station • Buffalo, NY 14217

Street Address: 2200 Military Rd. • Tonawanda, NY 14150

(800) 766-3969 • Phone: (716) 692-3680 • Fax: (716) 693-3402

Contact us at [info@martinfireproofing.com](mailto:info@martinfireproofing.com)

[www.martinfireproofing.com](http://www.martinfireproofing.com)